

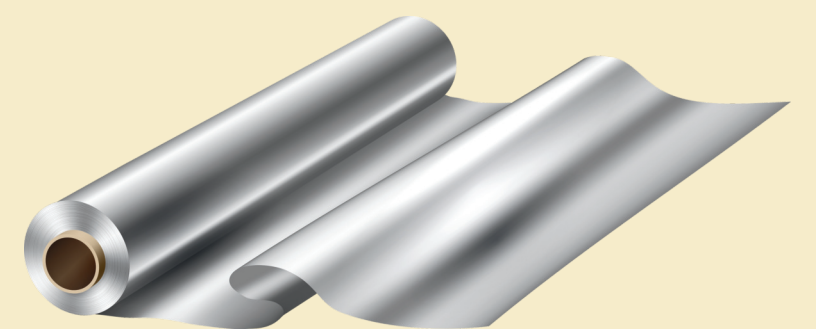

MIXED RECYCLABLES

Paper

- Books (no hard covers)
- Computer paper
- Construction paper
- Envelopes
- Loose-leaf paper
- Magazine and glossy paper
- Kraft paper
- Paper bags
- Newspapers and flyers
- Milk cartons
- Egg cartons (paper)*
- Food boxes
- Cardboard packing materials
- Paper towel/toilet paper rolls
- Corrugated cardboard (broken down)
- Drink trays (e.g. for takeout coffee)



Mixed Plastics

- Plastic food containers (e.g yogurt, butter containers)
- Plastic food storage containers
- Plastic milk bottles
- Plastic household cleaner bottles (dishwashing or handwashing soap)
- Plastic flower pots
- Plastic toiletry bottles

Metals

- Aluminum foil (not used for cooking)
- Tin cans
- Disposable foil containers

Special instructions:

- Please wash food containers
- Many beverage bottles are returnable - place with "Returnable Beverage Containers"
- Paper egg cartons can also be composted - see Composting posters
- Large corrugated cardboard boxes (shipping boxes) can be placed on the floor next to sorting stations for pick-up